

April 6, 2021

**SUBJECT:** Equine CT Room Renovation – CVM Main  
Pre-Submittal Meeting for Design Services

### **Introductions & Welcome**

- Point of Contact of University  
Melanie Butler  
mdbodenh@ncsu.edu  
(919) 515-8059

### **Project Scope**

- The project is located at CVM Main Building, 1060 William Moore Drive, in the West Campus Precinct.
- This project renovates room D220 and D220D in the CVM Main Building to accommodate future medical CT equipment and new hoist. This will allow staff to improve how equine are handled during the procedure. The scope includes structural improvements for new equine hoist, equipment radiation shielding, reinforced concrete pit for future standing CT scan system and hydraulic table. This renovation will also update the room conditions to meet washdown requirements.

### **Project Budget**

- The total project budget of \$600,000 incorporates all design fees, reimbursable expenses, construction and associated costs.
- The anticipated cost of work is \$450,000

### **Project Schedule**

- Proposals due on April 16, 2021 at 5:00pm
- Shortlist will be created by end of April
- Pre-interview
- Interview date in early May

### **Critical Selection Factors**

- Experience and expertise with project type.
- Past performance on similar projects.
- Experience in design projects to be part of an existing campus context.
- Adequate staff and proposed consultant team – qualifications and examples of previous collaborations.
- Historically Underutilized Business representation in proposed consultant team.
- Current workload and State projects awarded.
- Proposed design approach or methodology.
- Recent experience with project cost estimates and schedule adherence.
- Construction administration capabilities.
- Record of successfully completed projects without major legal or technical problems.
- A minimum of three references with current contact information.

## Equine CT Room Renovation

### Location





## Anticipated Scope

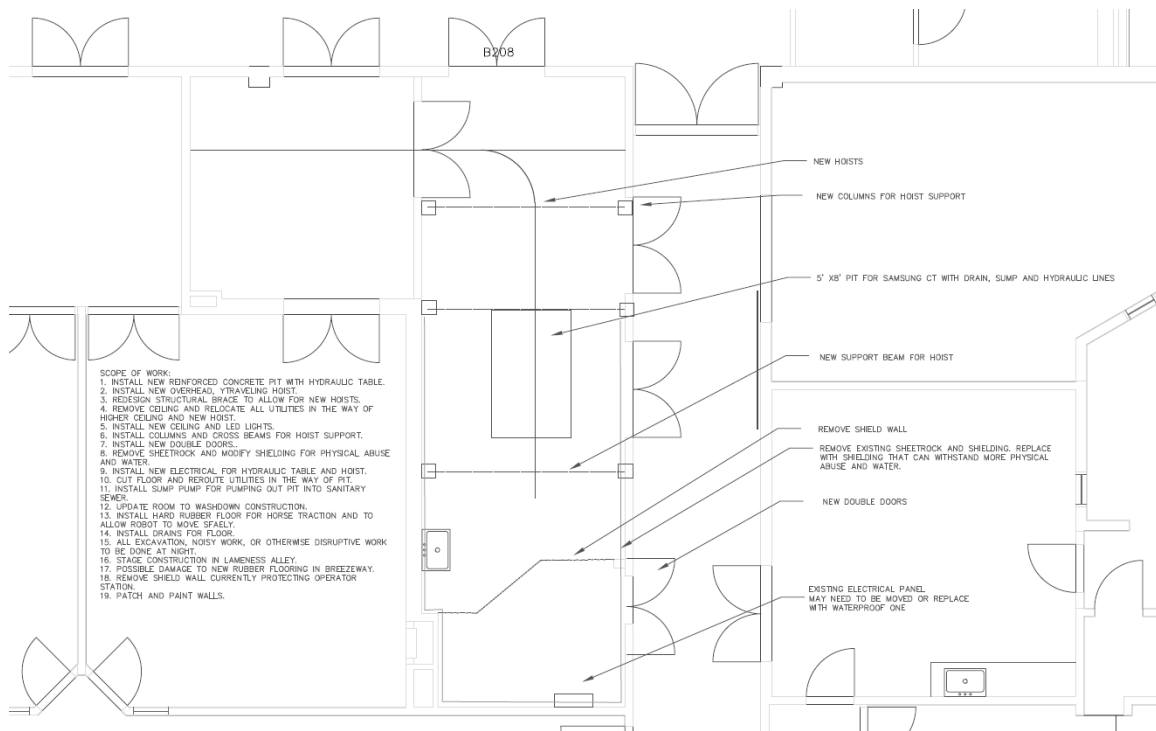

## Meeting Notes

- Is a hard copy of the SF330 form/submittal required?

No. Only electronic copies will be accepted sent via email to the project manager.

- Was there a study completed on this project?

No.

- Are existing structural drawings available?

Yes. They will be made available to the selected design team.

- Do we need a radiation physicist on the team?

No. NC State plans to hire the radiation physicist directly.

## Equine CT Room Renovation Pre-submittal Meeting Sign In

Timestamp	Email Address	Name	Company
4/6/2021 14:08:52	david@rndpa.com	David Daniel	RND Architects, PA
4/6/2021 14:08:59	mcheves@djginc.com	Milissa Cheves	DJG, Inc.
4/6/2021 14:08:59	pkitchens@newcomb-boyd.com	Paul Kitchens	Newcomb & Boyd
4/6/2021 14:09:01	sreyes@dwlarchitects.com	Sofia Reyes	DWL Architects + Planners, Inc.
4/6/2021 14:09:02	kwagner@wagnerarch.com	Kim Wagner	Wagner Architecture pllc
4/6/2021 14:09:07	cherndon@daa.com	Chris Herndon	Draper Aden Associates
4/6/2021 14:09:09	mwolter@dwlarchitects.com	Melissa Wolter	DWL Architects
4/6/2021 14:09:10	twiley@bhdp.com	Tom Wiley	BHDP Architecture
4/6/2021 14:09:10	mgarrett@szostakdesign.com	Megan Garrett	Szostak Design
4/6/2021 14:09:14	rdepaul@rfarchitects.com	Rosetta DePaul	Rauhaus Freedenfeld & Associates
4/6/2021 14:09:17	pharry@dewberry.com	Paul Harry	Dewberry Engineers Inc
4/6/2021 14:09:35	Elisabeth@RNDarchitects.com	Elisabeth Mansfield	RND Architects, PA
4/6/2021 14:09:50	tmurphy@palaciocollaborative.com	Tony Murphy	Palacio Collaborative (HUB Cost Consultant)
4/6/2021 14:10:01	dalder@cplteam.com	David Alder	CPL
4/6/2021 14:10:07	michele.lewis@rmf.com	Michele Lewis	RMF Engineering
4/6/2021 14:10:16	n.isley@IHRarchitecture.com	Nathan Isley	IHR Architecture
4/6/2021 14:11:50	lbrown@dwlarchitects.com	Lorin Brown	DWL Architects + Planners, Inc.
4/6/2021 14:11:52	dennis@edmpa.com	Dennis Hayes	Edmondson Engineers